



HapLog

Haptic Skill Logger

'Finger as a Sensor' - Quantifying the Sense of the Finger

Features

- ◇ Exposed fingertip allows measurement without losing finger sensation
- ◇ Five sizes available for the Finger Sensor with measurement up to 30N
- ◇ Finger Sensor has a built-in 3-axis accelerometer
- ◇ Easy measurement steps including calibration

接触力センサと
3軸加速度センサを内蔵

センサ(以降、指センサ)
は指腹を邪魔しない
コの字形状

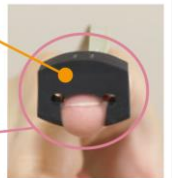

Principle

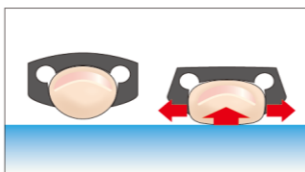

The sensor detects finger pad deformation.

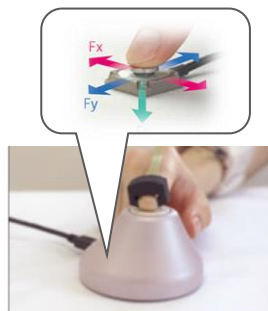

Calibrator with an integrated load sensor measures pressing force.

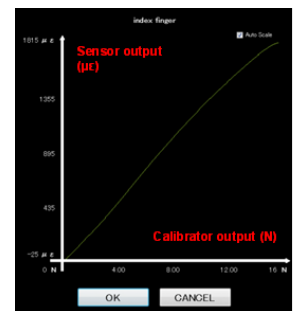

The changes of finger deformation and pressing force are converted to physical quantities.

Versatility

Multi-finger Measurement

Up to 3 channels can be measured simultaneously with a single HapLog.
Five sizes of sensors are available according to the finger size and expected load.



External TRIG-in Option

In order to perform measurement simultaneously with other devices, the HapLog amplifier can be modified to attach an external TRIG-in connector, which allows the start of recording when a contact signal is received.



Applications



Medical

Operation abilities
Rehab effects



Automobile

Usability evaluation
of steering wheels/
interior materials



Appliances

Usability evaluation



Game/Sports

Usability evaluation
of buttons/grips



Virtual Reality

Sensing finger sensation

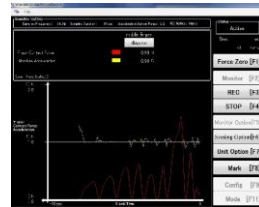

Contact force and 3-axis acceleration



Data output

Specifications

Model	HapLog
Components	Contact force sensor (1) *Size selected at the time of purchase Connection box (1), Calibration unit (1), USB cable (2) Software, Manual, Storage box
Option	External trigger function of the connection unit (Contact/IN signal)
Wearable Contact Sensor	
Sizes	Inner width: 11mm, 12mm, 14mm, 16mm, 18mm
Integrated sensor detections	Strain (shown as load value after calibration) 3-axis acceleration
Calibration Unit	
Rated capacity	30 N
Resolution	16-bit

System

ハードウェアは指センサ・アンプ(腕に装着)・校正器のみのシンプルな構成です。



持ち運びが容易な収納ボックス



キャリブレーションユニット
(校正器)



コネクションボックス
(アンプ)



コンタクトフォースセンサ
(指センサ)

※システムご購入で1本付属
(追加のご購入も可能です)

※その他にUSBケーブル×2、ソフトウェアインストールディスク、取扱説明書が同梱

***The design and specifications are subject to change without prior notice.**

Tec Gihan Co., Ltd.

1-22 Nishinohata, Okubo-cho, Uji-city, Kyoto 611-0033 Japan

Tel: +81-774-48-2334

E-mail: eigyo@tecgihan.co.jp

URL: <http://www.tecgihan.co.jp/>